

Spring-return system

Ideal for lathes with limited space;
enables marking directly at a shoulder



Tool set 422



Product features

- Modular shank design:
shank size 8 x 8 mm,
adaptable
- Top edge of shank =
centre height
- Set screws in shank for
correcting alignment
- Possible to mark workpieces
up to a shoulder
(for 15 x 7 x 6 mm marking roll)
- Hardened pin
- Right spring (pre-mounted)
for spindle direction M3 (CW),
see page 27

Set consisting of

- 1 x base shank (solid shaft
version) tool 422-08R
- 1 x shank adapter 10 x 10 mm
- 1 x shank adapter 12 x 12 mm
- 1 x shank adapter 16 x 16 mm
- In high-quality case

TOOL SET

Order no.	Tool holder designation	Dimension [mm]						
		a	b	c	d	e	f	x
31002843	422-08R150506-A	8	8	101	24	21	16	1
	With shank adapter 10 x 10 mm	12	12	101	24	21	18	1
	With shank adapter 12 x 12 mm	12	12	101	24	21	20	1
	With shank adapter 16 x 16 mm	16	16	101	24	21	24	1

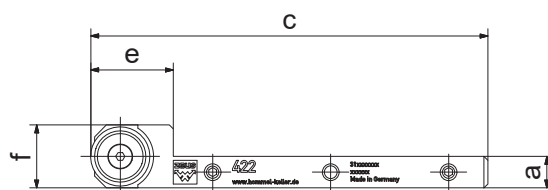

E-KIT

Order no.	Direction	
21BHR1505	right	

Set and E-kit also available in l/h version on request

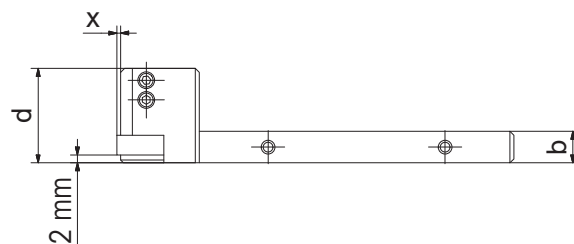

TOOL SET UP TO A SHOULDER

Order no.	Tool holder designation	Dimension [mm]						
		a	b	c	d	e	f	x
31002846	422-08R150706	8	8	101	24.5	21	16	1
	With shank adapter 10 x 10 mm	10	10	101	24.5	21	18	1
	With shank adapter 12 x 12 mm	12	12	101	24.5	21	20	1
	With shank adapter 16 x 16 mm	16	16	101	24.5	21	24	1

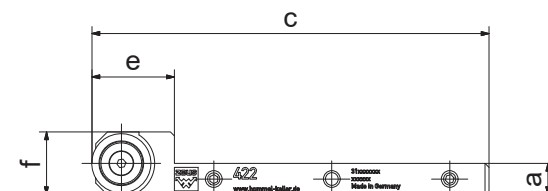

E-KIT

Order no.	Direction	
21BHR1507	right	

Set and E-kit also available in l/h version on request

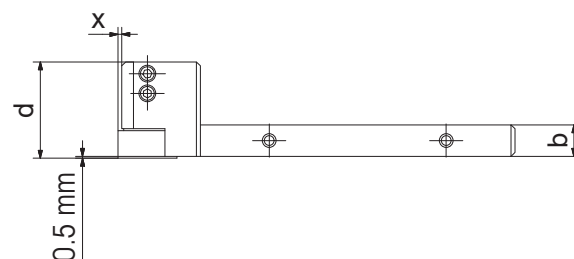

Marking roll n° 41



Benefits

- Especially versatile since it is independent of the workpiece diameter
- Marking is possible at high speed

Features

- The design of marking roll n° 41 is independent of the workpiece diameter
- Three driving points guarantee a perfect impression. They may be placed to the side of the characters
- Full depth and definition are accomplished in one go
- All characters can be used as a drive, e.g. logos, backlash, asterisks, number signs, etc.

Application

- Precise positioning of characters on workpiece circumference
- Centre height corresponds to first marking point
- Marking positions can be set as desired
- Possible to mark workpieces up to a shoulder

Standard design		For marking tools
Flank angle	90°	422
Dimensions (Ø x width x bore) [mm]	15 x 5 x 6 15 x 7 x 6	
Typeface	According to DIN 1451	
Max. character height	See "Technology" starting on page 20	