

## DR61 Chaser Screw Component Parts

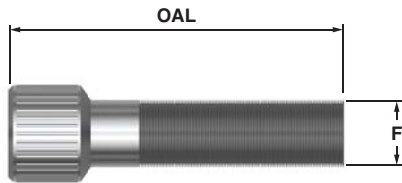

Diehead 4 Per Set	Chaser Length	Screw Diameter	OAL	EDP#	
				Left Hand	Right Hand
1/4 & 5/16	1/4 & 3/8	6-32	5/8	3196	3219
	1/4	8-32	1/2	3186	3211
3/8 & 9/16	9/16	12-28	15/16	3185	3210
	3/4	12-28	1 7/32	3189	3214
13/16 & 1" & 1 1/16	9/16	1/4-28	1 5/32	3184	3209
	3/4	1/4-28	1 3/8	3187	3212
1 5/8 & 2"	7/8 & 1"	1/4-28	1 9/16	3181	3206
	5/8	3/8-24	1 3/16	3178	3202
	7/8	3/8-24	1 7/16	3179	3203
1 5/8 & 2" Heavy Duty	1 1/8	3/8-24	1 11/16	3188	3213
	5/8	5/16-24	1 7/16	3190	3215
	7/8	5/16-24	1 11/16	3191	3216
2 3/8	1 1/8	5/16-24	1 15/16	3192	3204
	3/4	3/8-24	1 7/16	3179	3203
	1"	3/8-24	1 11/16	3188	3213
	1 1/8 & 1 1/4	3/8-24	1 15/16	3180	3205

Diehead 5 Per Set	Chaser length	Screw Diameter	OAL	EDP#	
				Left Hand	Right Hand
13/16 & 1"	9-16	12-28	15/16	3185	3210
	3/4	12-28	1 7/32	3189	3214
1 5/8	9/16	1/4-28	1 5/32	3184	3209
	3/4	1/4-28	1 3/8	3187	3212
	7/8 & 1"	1/4-28	1 9/16	3181	3206
	1 1/8	1/4-28	1 25/32	3183	3208
2 3/8	5/8	3/8-24	1 3/16	3178	3202
	7/8	3/8-24	1 7/16	3179	3203
	1 1/8	3/8-24	1 11/16	3188	3213

## DR63 Chaser Serrated Bushing Chart

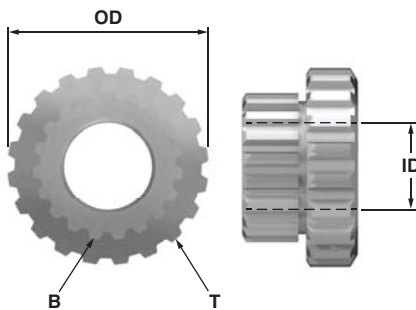

### 4 Chaser Style

EDP No.	Diehead	Number of Teeth		OD	ID	H
		(Bottom) (Top)				
		B	T			
3145	1/4"-5/16"	30	29	1/4"	9/64"	5/32"
3055	3/8"-9/16"	20	19	1/2"	7/32"	9/32"
3069	13/16" - 1"-11/16"	22	23	5/8"	1/4"	9/32"
3056	1 5/8-2"	27	26	7/8"	3/8"	9/32"
3098	1 5/8"-2" HD	25	26	3/4"	5/16"	9/32"
3072	2 3/8"	27	26	15/16"	3/8"	7/16"

### 5 Chaser Style

EDP No.	Diehead	Number of Teeth		OD	ID	H
		(Bottom) (Top)				
		B	T			
3055	13/16 - 1"-11/16"	20	19	1/2"	7/32"	9/32"
3069	1 5/8"	23	22	5/8"	1/4"	9/32"
3056	2 3/8"	27	26	7/8"	3/8"	9/32"

\*Made from HSS- Not powdered metal